

Leaside-Laird CLC

Eglinton Crosstown LRT

March 13, 2023

LAND ACKNOWLEDGEMENT

Let us take a moment to acknowledge we are on lands that have been, and continue to be, home to many Indigenous Peoples including the Anishnabeg, the Haudenosaunee and the Huron-Wendat peoples.

We are all Treaty people. Many of us have come here as settlers, as immigrants or involuntarily as part of the trans-Atlantic slave trade, in this generation, or generations past.

We acknowledge the historic and continued impacts of colonization and the need to work towards meaningful reconciliation with the original caretakers of this land.

We acknowledge that Metrolinx operates on territories and lands covered by many treaties that affirm and value the rights of Indigenous communities, Nations and Peoples.

We understand the importance of working towards reconciliation with the original caretakers of this land. At Metrolinx, we will conduct business in a manner that is built on a foundation of trust, respect and collaboration.

Leaside Station

LEASIDE STATION UPDATE

Activity	Location	Approx. Date & Duration
Station Box Construction Architectural finishes, mechanical electrical works, and testing and commissioning	Underneath Eglinton Avenue within the Station Box	Underway through Spring 2023
Main Entrance Construction Architectural works, mechanical electrical installations, and landscaping	South east corner of Bayview Ave and Eglinton Ave	Underway through Spring 2023
Secondary Entrance Construction Architectural works, mechanical electrical installations, and landscaping	North west corner of Bayview Ave and Eglinton Ave	Underway through Spring 2023
Utility Reinstatement Works, and Road, Sidewalk, and Bike Lane Construction Short-term lane closures may be required to facilitate this work	Eglinton Ave and Bayview Ave	Underway through Spring 2023
Final Paving and Traffic Line Painting	Eglinton Ave and Bayview Ave	Spring 2023

CURRENT TRAFFIC CONFIGURATION

Expected through Spring 2023

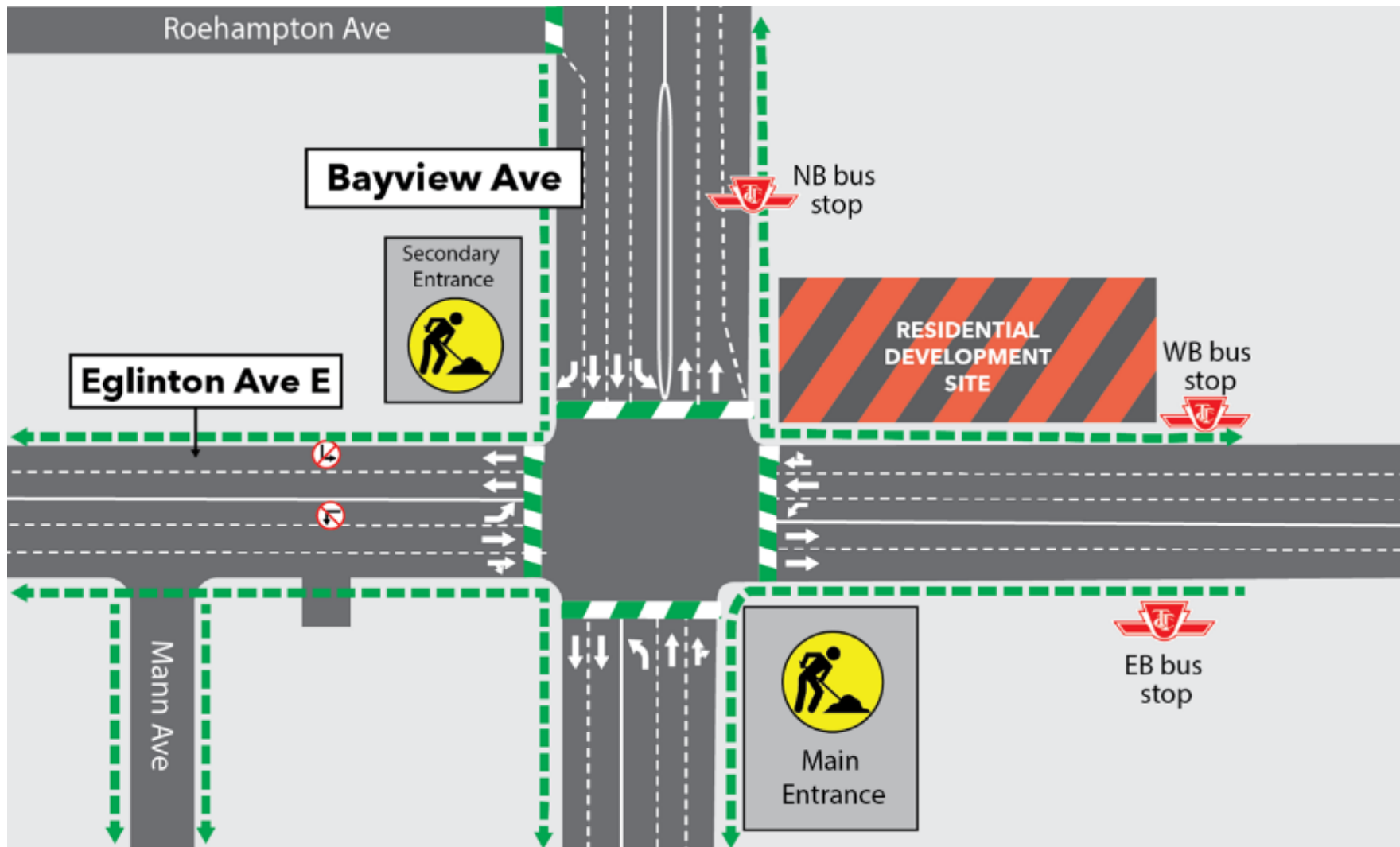

CONSTRUCTION PROGRESS PHOTOS

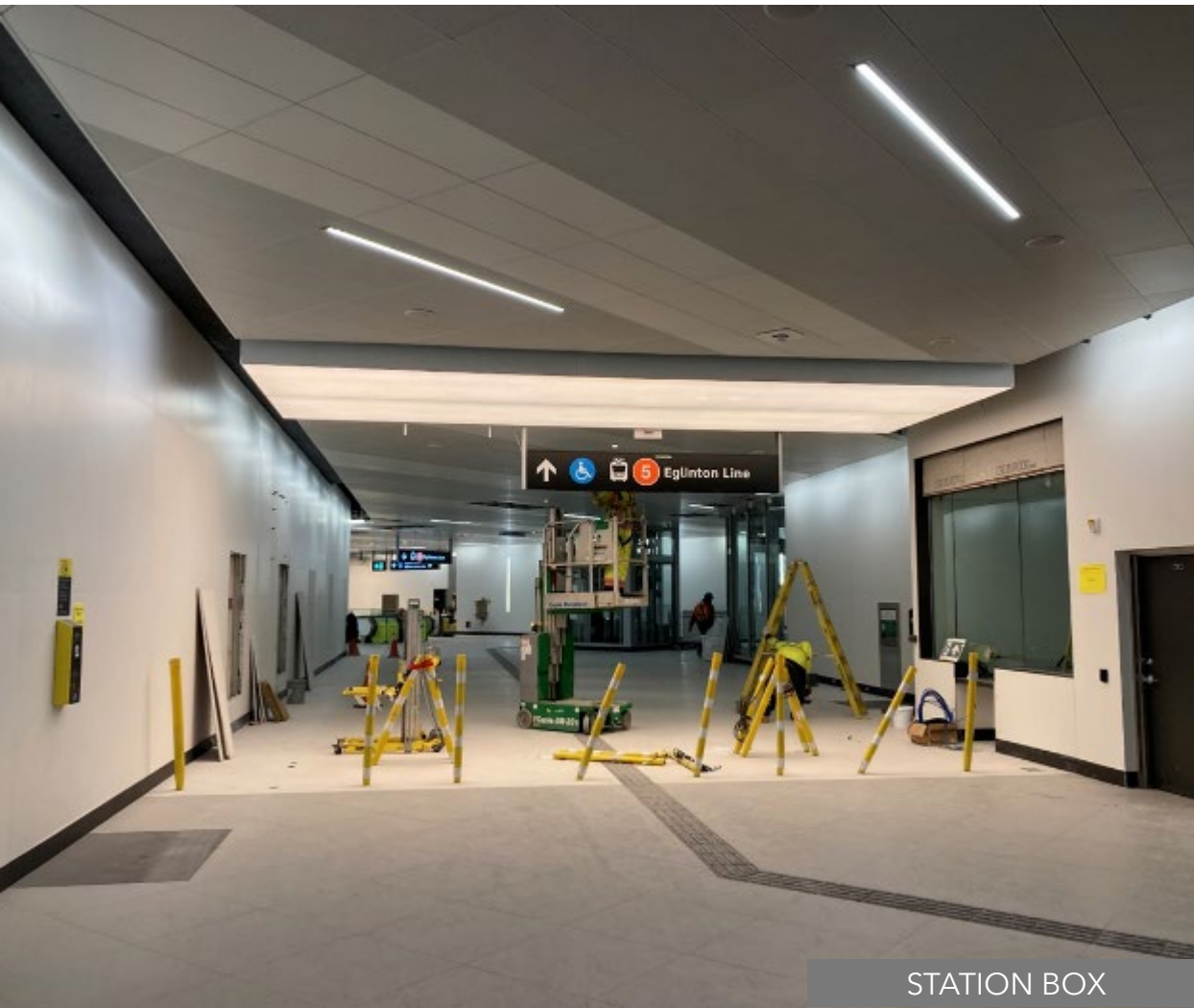

STATION BOX



MAIN ENTRANCE

Laird Station

LAIRD STATION UPDATE

Activity	Location	Approx. Date & Duration
<p>Main Entrance Construction Electrical, mechanical, and architectural finishes. Sidewalk pours and station cleaning.</p>	<p>South-west corner of Laird Drive and Eglinton Avenue East</p>	<p>Underway through early 2023</p>
<p>Secondary Entrance Construction Electrical, mechanical, and architectural finishes. Landscaping restoration works, and station cleaning.</p>	<p>South-east corner of Laird Drive and Eglinton Avenue East</p>	<p>Underway through early 2023</p>
<p>Station Box Construction Electrical, mechanical, and architectural finishes. Station and systems testing and inspections, and station cleaning.</p>	<p>Beneath Eglinton Avenue East</p>	<p>Underway through early 2023</p>
<p>Periodic Lane Reductions Decommissioning Monitoring Wells</p>	<p>Eglinton Avenue East between Sutherland Drive and Brentcliffe Road</p>	<p>Ongoing until approx. late-April 2023</p>

PERIODIC LANE REDUCTIONS FOR DECOMMISSIONING MONITORING WELLS

Ongoing until approximately late-April

- Rolling lane closures are required to complete this work.
- Periodically, Eglinton Ave East and Laird Dr will be reduced to one lane in each direction, while this work takes place.
- A short-term road closure may also be required on Sutherland Dr and Don Avon Dr to complete this work
- Decommissioning each well will take approximately two-four hours; upon completion, crews will move onto the next well.
- Noise from construction activities can be expected.
- Work is expected to take place between 7:00 a.m. and 5:00 p.m.

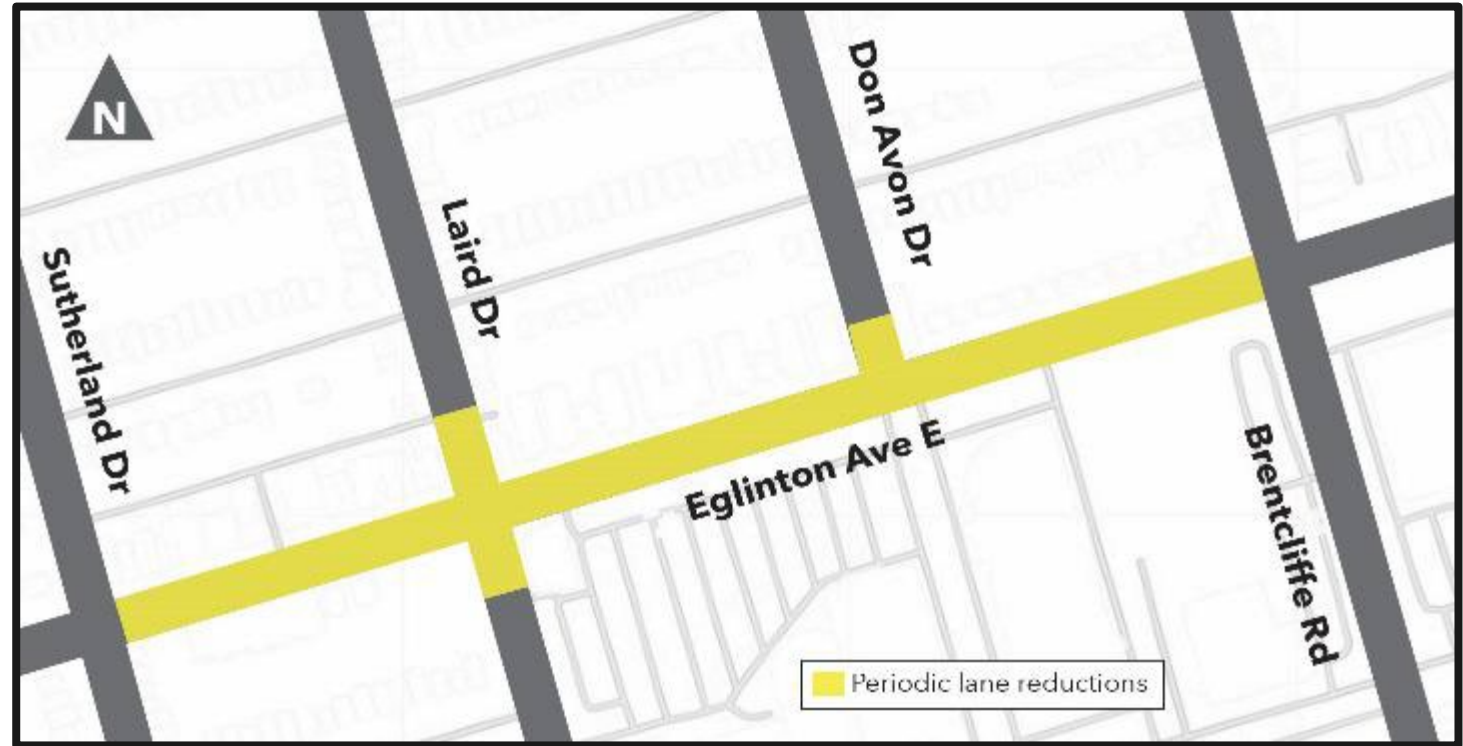

TRAFFIC CONFIGURATION AT LAIRD STATION - CROSSWALK REMOVAL

Through 2023



- Periodic short-term lane closures will be required during this traffic stage to facilitate specific activities
- Fencing will remain in place around the Station Entrances for security purposes

CONSTRUCTION PROGRESS PHOTOS

SIGNAGE INSTALLATION ONGOING
THROUGHOUT THE STATION



CLEANING ONGOING
THROUGHOUT THE STATION



EAST OF LAIRD ONGOING WORKS

- Vehicle testing
- Landscaping between Brentcliffe Road and Kennedy Road - Ongoing through early-Summer 2023
- Brentcliffe retaining wall landscaping restoration works - Ongoing through early-Summer 2023
- Multi-use path construction and landscaping restoration works - Ongoing through late-Spring 2023
- Watermain restoration work on Eglinton at Gervais Drive - Resuming mid-Spring 2023
- Soil nail and noise barrier wall removal - Resuming mid-Spring 2023, and expected to be completed by late June 2023



RETAINING WALL LOCATIONS

